

83 KING LAM STREET

LEASING PARTICULARS

we create
we are artisans
we are csv.

The Artisanal Movement



New Commercial Hub

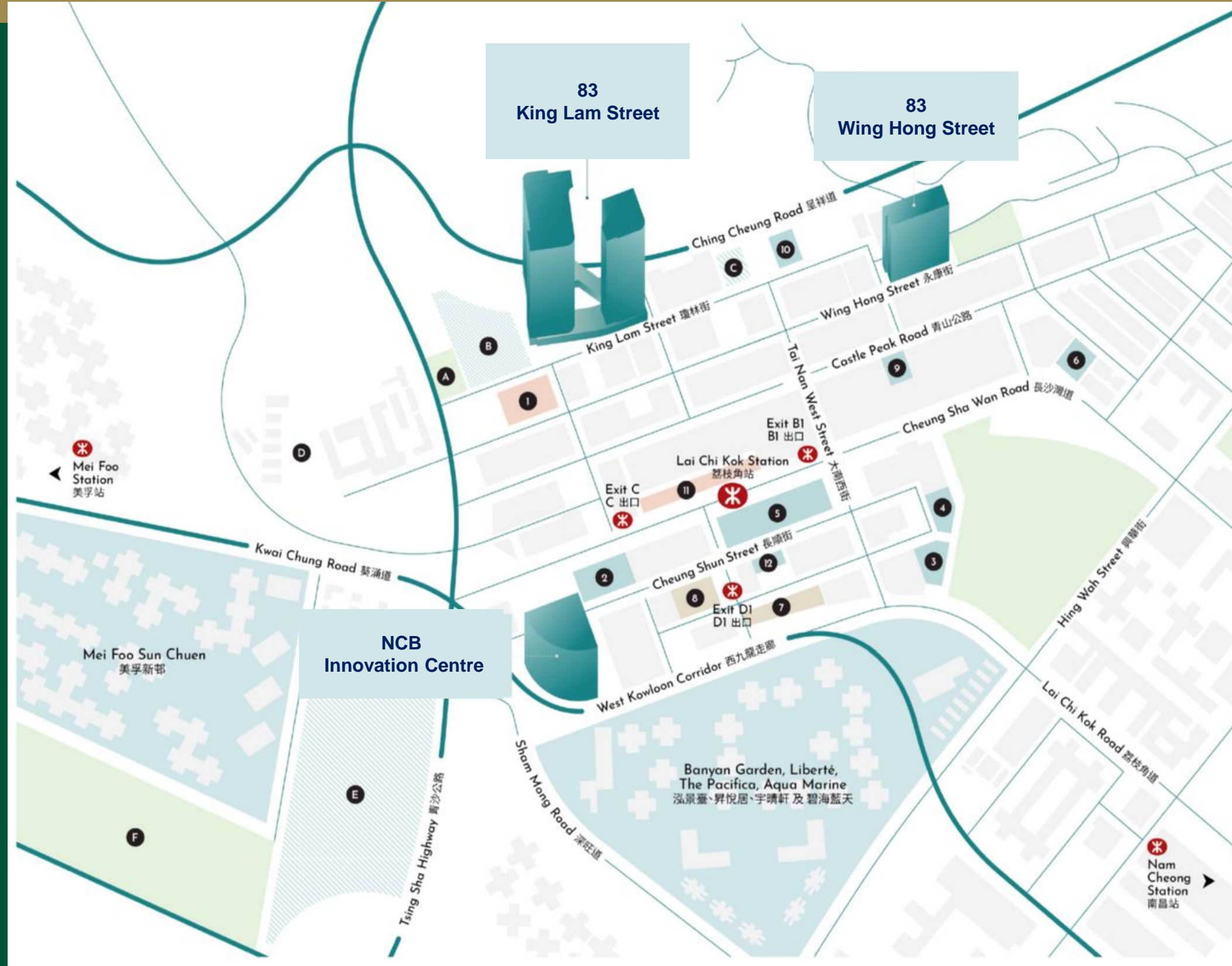

Strategic Location

we create
we are artisans
we are csv.

The Artisanal Movement

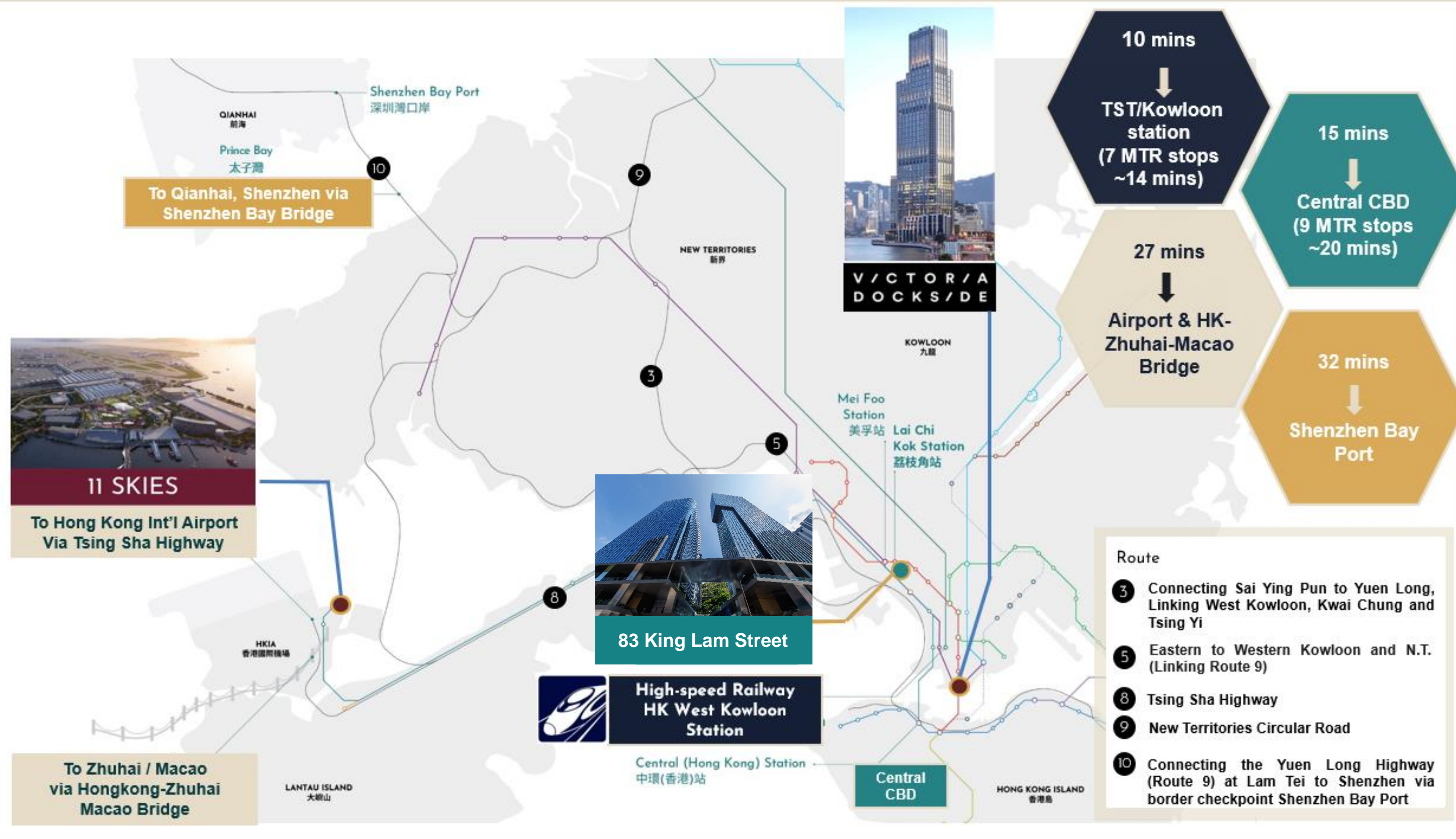



Sustainable Architecture with ESG



Beam Plus
Provisional Gold



WELL
Targeted “Platinum”

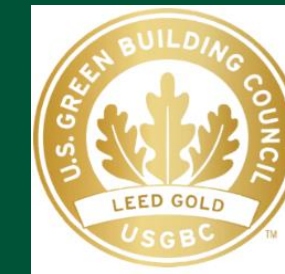

LEED
Targeted
“Gold”



Best Futura
Project
Silver



Upcoming carparking facilities with EV chargers and EV Zone



Sustainability & Creating Shared Value

An event space that can let you host up to 300 pax for increasing your brand exposure and building the community at our Townhall

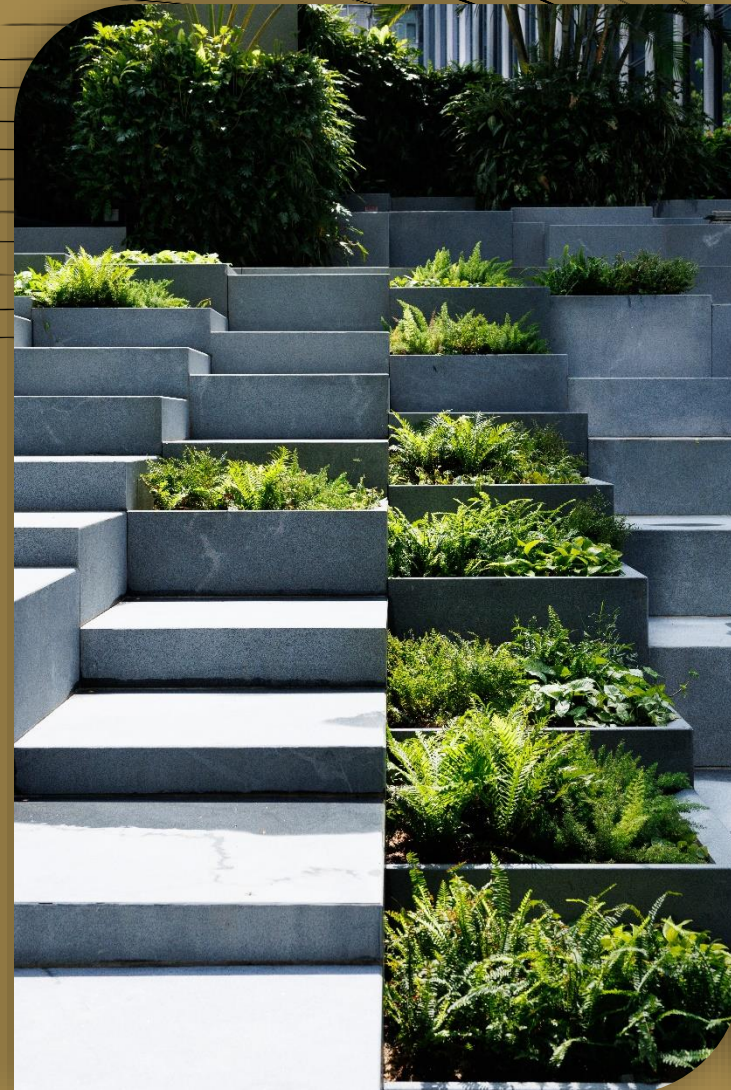

An amalgamation of modern design and green features including 27,000 sf greenery coverage, Spanish steps and Vertical Greenery

2021
WINNER
BEST FUTURA PROJECT
SILVER

The MIPIM Asia Awards

mipim
ASIA AWARDS

The first Grade A building in Kowloon West being awarded the Best Futura Project (Silver)

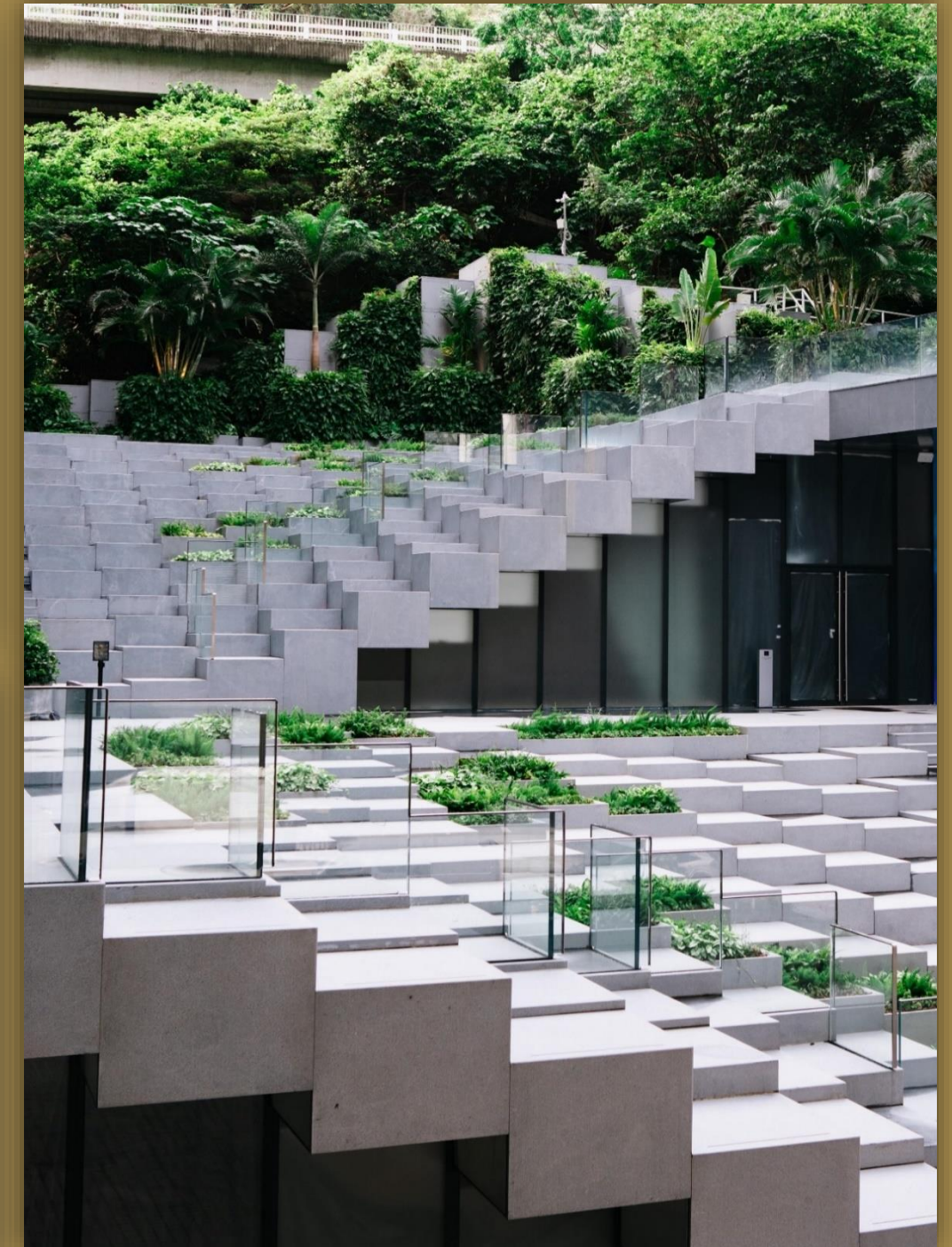
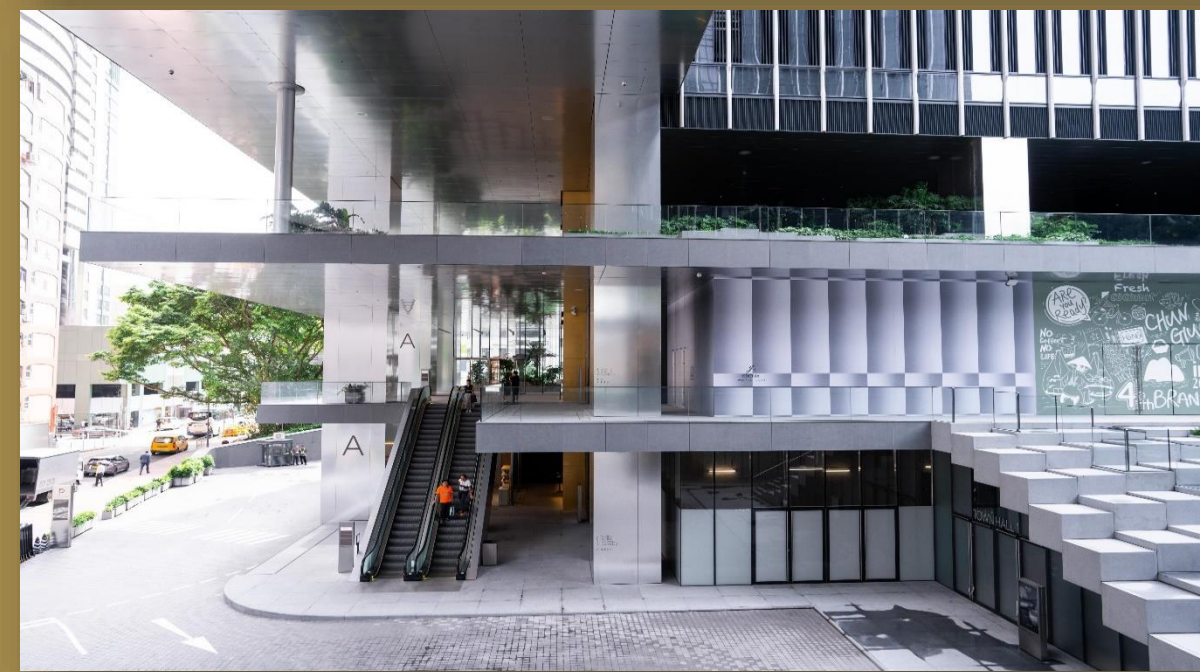



Tower A

Tower B

Executive Floors (29/F – 30/F)

Zone 3 (Typical floor: 31,607 ft² – 31,617 ft²)
(23/F, 25/F – 30/F) 221,299 ft²

Zone 2 (Typical floor: 31,607 ft² – 32,999 ft²)
(15/F – 22/F) 256,982 ft²

Zone 1 (Typical floor: 32,299 ft² – 32,974 ft²)
(5/F – 12/F) 262,442 ft²

E&M

Carpark Basement (B1/F – B3/F)
351 nos. of carpark spaces

Executive Floors (29/F – 30/F)

Zone 2 (Typical floor: 17,930 ft² – 18,332 ft²)
(19/F – 23/F, 25/F – 30/F) 200,458 ft²

Zone 1 (Typical floor: 16,716 ft²)
(5/F – 12/F, 15/F – 18/F) 200,592 ft²

E&M

Podium Garden (2/F)

Landscape Plaza (G/F – 1/F)

General Particulars - Tower A

	Low Zone (5/F – 12/F)	Mid Zone (15/F – 22/F)	High Zone (23/F, 25/F – 30/F)	
Whole Floor GFA	Approx. 32,974 ft²	Approx. 32,607 – 32,999 ft²	Approx. 31,607 ft² – 31,617 ft²	
Clear Ceiling Height Floor to Floor Height	<ul style="list-style-type: none">2.8m4.25m	Clear Ceiling Height	<ul style="list-style-type: none">2.8m	
		Clear Ceiling Height (29/F-30/F)	<ul style="list-style-type: none">3.1m	
		Floor to Floor Height	<ul style="list-style-type: none">4.25m	
		Floor to Floor Height (29/F)	<ul style="list-style-type: none">4.7m	
		Floor to Floor Height (30/F)	<ul style="list-style-type: none">4.95m	
Raised Floor System	<ul style="list-style-type: none">150mm			
Floor Loading	<ul style="list-style-type: none">3kPa			
Air-conditioning Supply Hours	<ul style="list-style-type: none">Mon – Fri (Except Sunday and Public Holidays) 08:00 - 19:00Sat Only (Except Public Holidays) 08:00 - 13:00			
Extra Air-Conditioning Charge	<ul style="list-style-type: none">HK\$0.03 per sq. ft., subject to revision. (min. charge is HK\$80/ hr)			
Features	<ul style="list-style-type: none">2 Executive Toilets1 Pantry1 Nursery Room4 passenger lifts per zoneExecutive Lounge with shower facilities (1/F Lobby)			

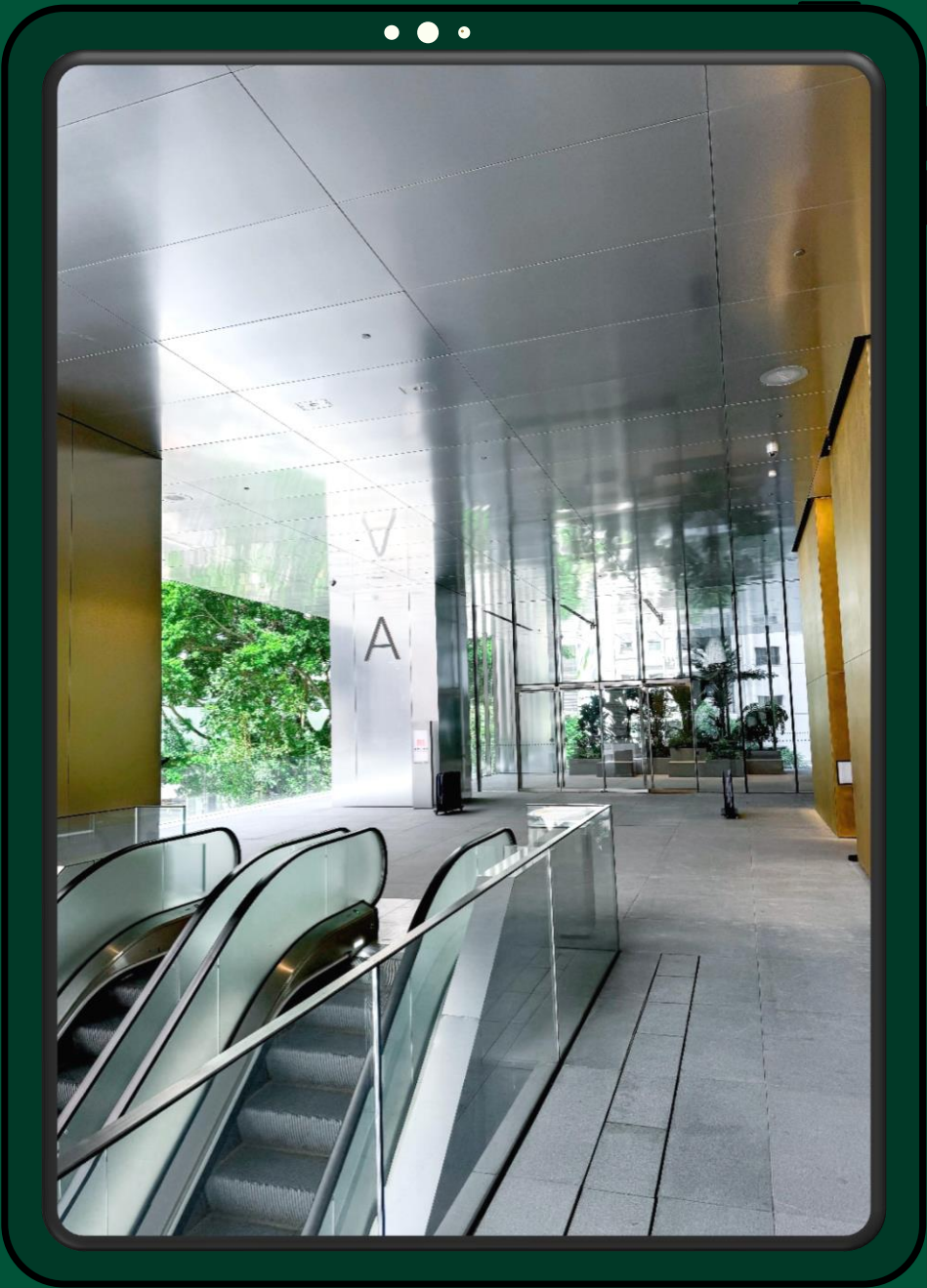

General Particulars - Tower B

	Low Zone (5/F – 18/F)	High Zone (19/F – 23/F, 25/F – 28/F)
Whole Floor GFA	Approx. 16,716 ft²	Approx. 17,560 - 17,991 ft²
Clear Ceiling Height	▪ 2.8m	
Floor to Floor Height	▪ 4.25m	
Raised Floor System	▪ 150mm	
Floor Loading	▪ 3kPa	
Air-conditioning Supply Hours	<div><div>▪ Mon – Fri (Except Sunday and Public Holidays) 08:00 - 19:00</div><div>▪ Sat Only (Except Public Holidays) 08:00 - 13:00</div></div>	
Extra Air-Conditioning Charge	▪ HK\$0.03 per sq. ft., subject to revision. (min. charge is HK\$80/ hr)	
Features	<div><div>▪ 1 Executive Toilet</div><div>▪ 1 Pantry</div><div>▪ 1 Nursery Room</div><div>▪ 4 passenger lifts per zone</div><div>▪ Executive Lounge with shower facilities (1/F Lobby)</div></div>	

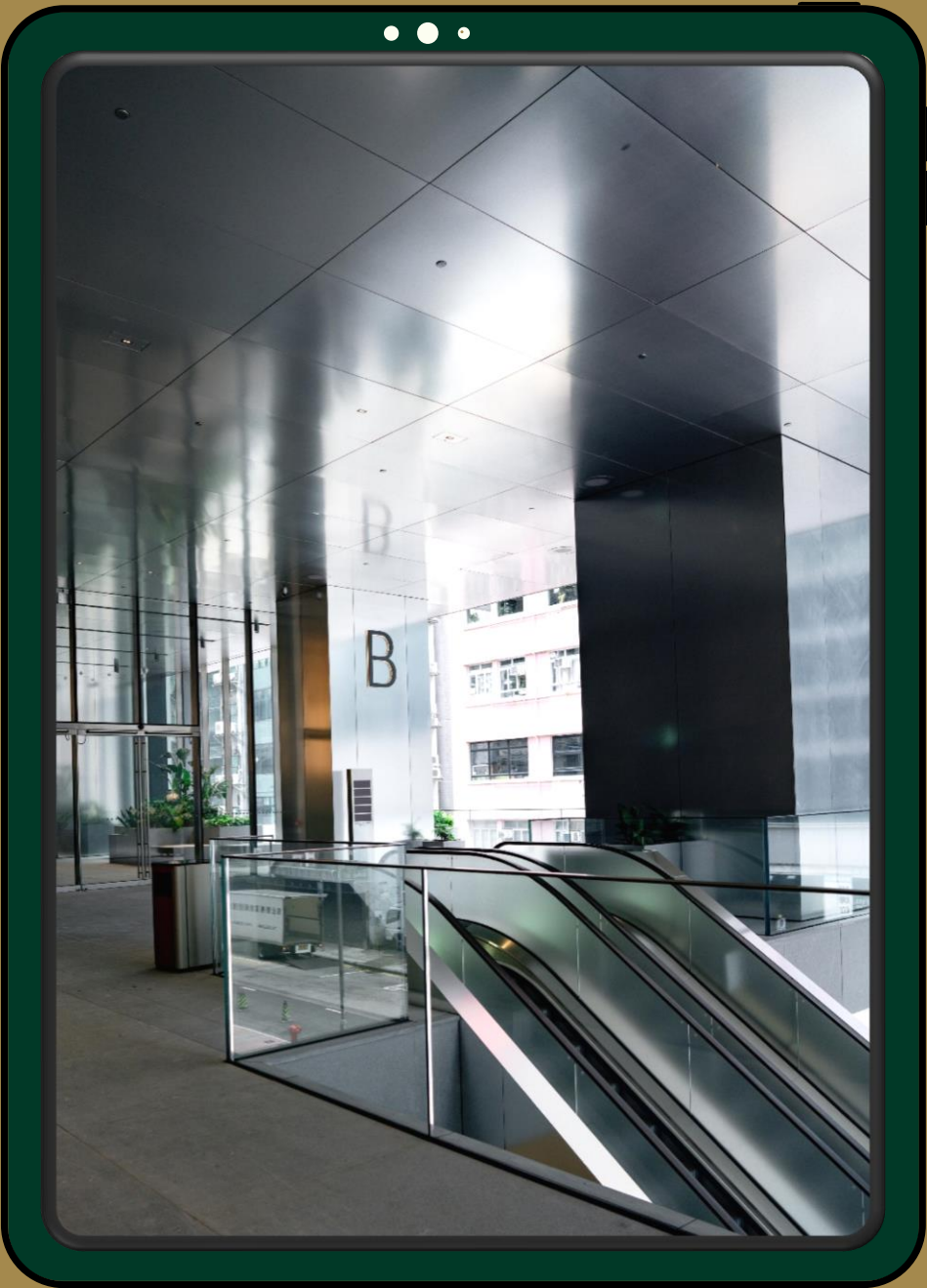

Typical Floor Plan

For identification and reference only

Not to scale

Tower A

Ching Cheung Road

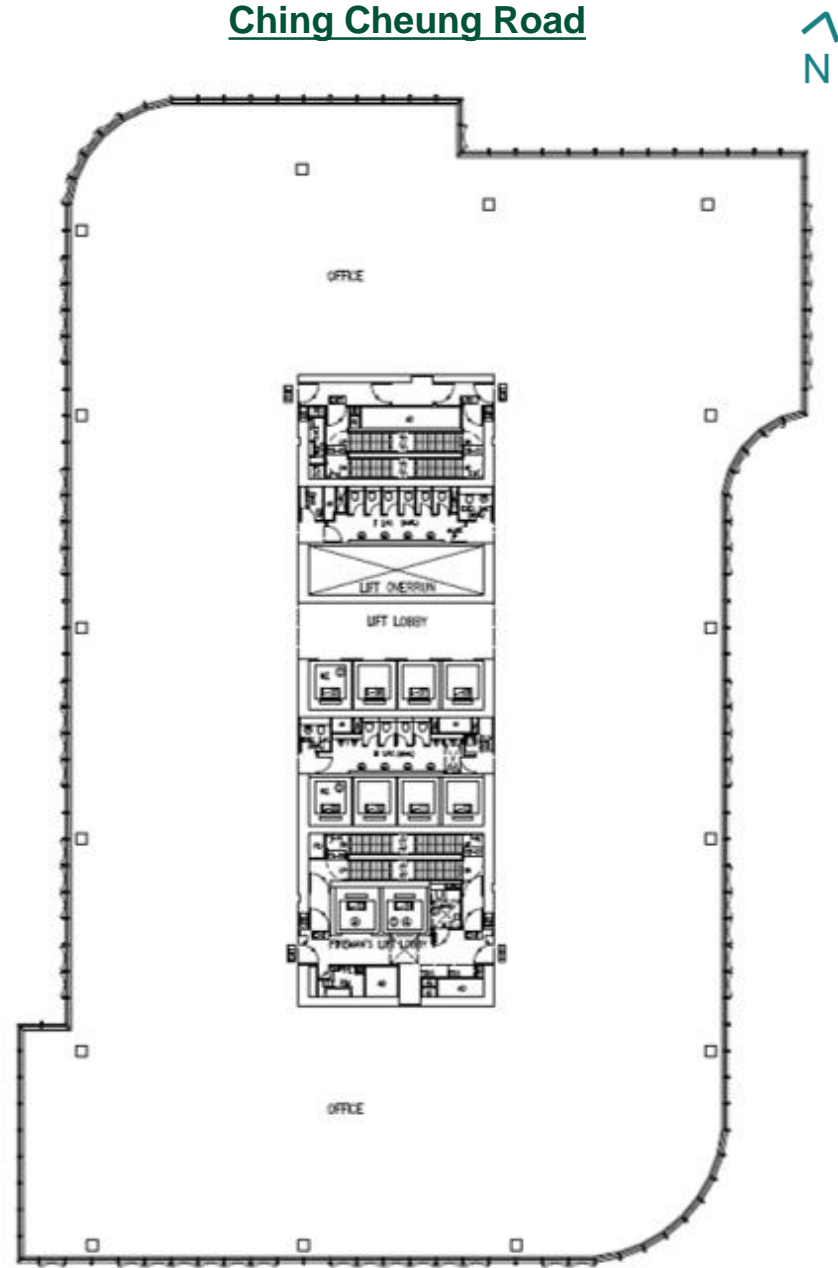

83 King Lam Street

Tower B

Ching Cheung Road

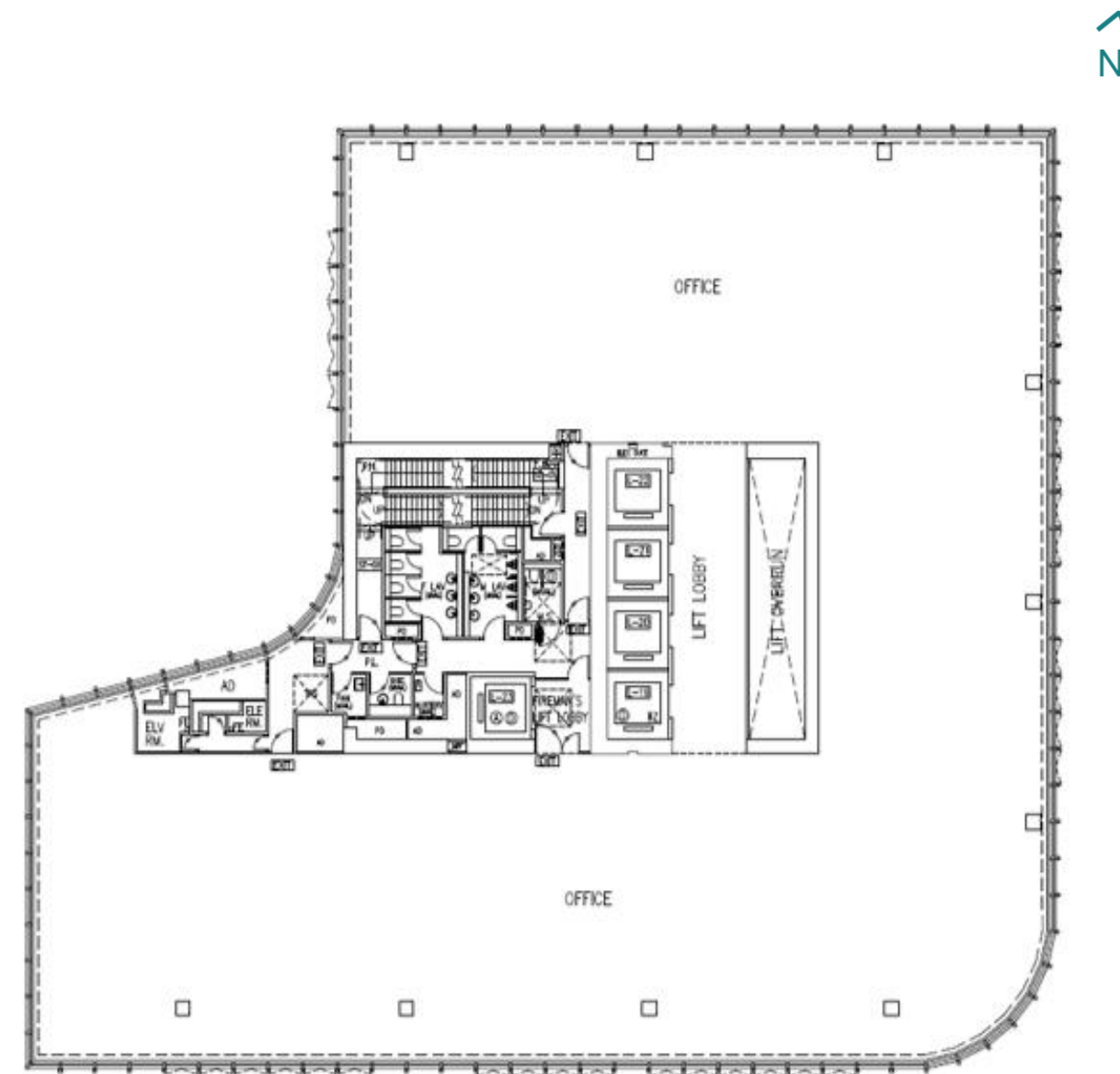

83 King Lam Street

Stay connected with us

Leasing Enquiry: (+852) 8134-9388

